

product warranty
3 years

AVAILABLE CONTRAST METHODS

- BRIGHTFIELD
- DRY DARKFIELD (OPTIONAL)
- PHASE CONTRAST (OPTIONAL)



- For phase contrast:
- Slider: Brightfield and Phase Contrast 10x/40 or
 - Slider: Brightfield, Dry Darkfield and Phase Contrast 10/40

Infinity corrected phase contrast objectives:
 IC02 Phase 10x/0,25 WD 10,20 mm, CC 0,17
 IC02 Phase 40x/0,65 WD 0,50 mm, CC 0,17

EYEPIECE MICROMETER

Micrometers are used to measure or count specimens. Optional we offer for our Lotus MCX51 two different eyepiece micrometers.

Reticula with scale on crossline 0,1mm With pointer



OBJECT MICROMETER

The available object micrometer is needed to calibrate the eyepiece micrometer.
 Object-micrometer: 1 mm divided into 100 units; 0,01 mm

MULTISYSTEM-CONDENSER



The high quality Abbb brightfield condenser nA. 125 with aperture iris and filter tray (green filter included) produces rich in contrast images. The scale for each objective ensures a quick preset for an optimal viewing result.

EASY UPGRADING

The available slider on the condenser allows an easy upgrade of the microscope into other observation methods like darkfield and phase contrast at a reasonable price.



Available sliders (optional)
 Brightfield and dry darkfield
 Brightfield and phase contrast 10/40
 Brightfield, dry darkfield and phase contrast 10/40

Lotus MCX51 - Specifications

		ECO	ECO PLUS	ECO SLIDE
Optical System	"PURE" Infinity corrected optical system	●	●	●
Standard Magnification Range	40x - 400x 40x - 1000x	●	●	●
Illumination System	Advanced LED optical lighting system Longlife LEDs (approx. 30.000 hours) 110-220V 50-60Hz	●	●	●
Microscope	Compact size W225/D324/H365, net weight 5,5 kg, sturdy base 203 x 145 Anti-fungus treatment for all optical parts	●	●	●
Focusing	Coaxial coarse and fine focus control, total focusing range 20 mm, graduation reading 2 µ per division, Coarse: 37,7mm/rotation, including tension adjustment and safety autofocus stop unit	●	●	●
Nosepiece	Quadruple reversed angle revolving nosepiece	●	●	●
Binocular Head	ARCTYPE binocular, 30° inclined, 360° rotatable, interpupillary distance 48-75 mm diopter adjustment	●	●	●
Trinocular Head	30° inclined, 360° rotatable, interpupillary distance 55 - 75 mm, diopter adjustment beam splitter 50:50	○	○	○
Stage	Rackless, double layer mechanical stage, 150 x 133 mm, stage movement up/down 20 mm, traveling range 76mm (X) x 30mm (Y), minimum reading 0,1 mm Rackless, double layer mechanical stage, 150 x 133 mm with exchangeable, ultra-hardened, unique, flexible glass plate with rounded edges for safe handling, stage movement up/down 20 mm, traveling range 76mm (X) x 30mm (Y), minimum reading 0,1 mm Sliding Stage - Double layer moveable round stage, Ø 160mm, moving range 19 x 40 mm, stage movement up/down 16 mm. For right hand and left hand use.	●	●	●
Condenser	Abbb Brightfield condenser with aperture iris, nA. 125, with scale for each objective, condenser movement range 23 mm slot in condenser for BF/DF attachment, BF/PC attachment and for BF/DF/PC attachment Slider for BF/DF attachment Slider for BF/PC 10/40 attachment Slider for BF/DF/PC 10/40 attachment	●	●	●
Objectives	Infinity corrected objectives "PURE" IC02 Plan 4/0,10, WD 23,5 mm, CC - "PURE" IC02 Plan 10/0,25, WD 10,0 mm, CC 0,17 "PURE" IC02 Plan 40/0,65, spring loaded, WD 0,54 mm, CC 0,17 "PURE" IC02 Plan 100/1,25, oil, spring loaded, WD 0,13 mm, CC 0,17 Infinity corrected phase contrast objectives "PURE" IC02 Plan 20/0,40, WD 5,1 mm, CC 0,17 "PURE" IC02 Plan 60/0,80, spring loaded, WD 0,14 mm, CC 0,17	●	●	●
Eyepieces (one pair)	WF 10x/18 Widefield, suitable to spectacle wearers, no additional eyecups required	●	●	●
SMART SENSE system	Clever energy saving (shut off after 15 minutes of no use)	●	●	●
Cord Rest	On the back of the microscope, for storing the power cord	●	●	●

Optional accessories

- Trinocular observation tube
- Documentation systems
- Phase contrast
- Dry Darkfield
- Eyepiece WF10x/20
- Eyepiece P16x/12
- Eyepiece WF10x/18 with pointer or reticule
- Stage micrometer 0,01 mm
- Daylight mirror unit
- Aluminium transport case
- Temperature controlled stage
- - standard ○ - optional

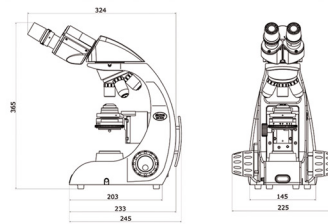

dimensions of carton
40,5x29x52 cm (LxWxH)
gross weight 7 kg

Microscope designs developed by MICROS AUSTRIA. Specifications and equipment are subject to change without any obligation on the part of the manufacturer.



MICROS Austria
 Humenbrunn - Gewerbezone 5
 9300 St. Veit/Glan, AUSTRIA
 Tel: 0043 4212/30901
 Fax: 0043 4212/30901 90
 office@micros.at
 www.micros.at

Breitenfurterstr. 38, 1120 Vienna, AUSTRIA

ENISO 9001 - Lotus MCX51 - Version 09/14



We are here for you



www.micros.at



LOTUS MCX51
 ECO - ECO PLUS - ECO SLIDE

micros
 AUSTRIA



micros micros micros micro

LOTUS MCX51

Equipped with premium features, MICROS AUSTRIA sets up a new standard in routine clinical microscopes. The high level infinity corrected optical system with the "PURE" 100^o Plan objectives provides clear, rich in contrast images and sets new standards for infinity optics in this class. The ergonomic and compact design makes it easy to set up, store and transport. LOTUS MCX51 delivers an outstanding performance in the fields of clinical laboratories, veterinary laboratories and biology, vitale also being an excellent choice for schools and universities. It impresses with innovative and well-known features made for long term use and is offering a reasonable price-performance ratio. Observers are going to experience the high quality sight at microscopic small life science objects with a fast and easy to use device.

EXCELLENT LIGHT AND BRILLIANT OPTICS



Optics
Observing objects with incredible color and sharpness through the whole field of view. The "PURE" 100^o Plan infinity corrected objectives create bright and clear images with convincing depth and contrast and set new standards for optics in its class.

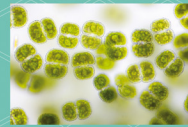

Advanced LED optical light system
MICROS advanced state of the art LED system ensures a bright and homogenous illumination of the whole object. With a lot less energy consumption and at the same time the much brighter intensity of the LED, this system is the future in premium quality LED lighting.



RACKLESS STAGE
ECO version offers a rackless stage which is another feature that gives pleasure working with this microscope. The missing rack eliminates the risk of injuries to the hand.



RACKLESS GLASS STAGE
ECO PLUS version offers an additional feature to the ECO version rackless stage. Our unique and patented glass stage. Our unique and patented glass stage. An exchangeable, ultra-hardened glass plate which is resistant against scratches and chemical fluids. The extra-safety glass and its finish machined edges guarantee safe and aesthetic work.



SLIDING STAGE
The sliding stage is a special type of specimen stage with a round plate instead of the standard rectangular plate. The greasy film under the plate creates a very smooth movement and without any need of specimen holders, positioning of objects is absolutely free and extremely fast. How does the sliding stage work - online video www.micros.at/Englisch/micros/lotus/ecoslide.html

ARCTYPE OBSERVATION TUBE AND EYEPIECES



Ergonomic ARCTYPE tube
To create a comfortable working position LOTUS MCX51 offers a binocular ARCTYPE tube as standard. With the possibility to set the eyepieces in two different positions (wide range of eyepoint height 350 - 395), small and tall users can have an ergonomic posture for long working hours without getting tired. With the interpupillary distance (48-75 mm) and the diopter adjustment the eyepieces easily fit to every user.



Trinocular tube
A trinocular observation tube is optional available: 30° inclined, 360° rotatable, interpupillary distance 55 - 75 mm, diopter adjustment, beam splitter 50/50.



Eyepieces
With the integrated eye shields, the eyepieces are suitable to spectacle wearers, without any need of additional eyecaps. The eyepieces are fixed on the observation tube to prevent loss.

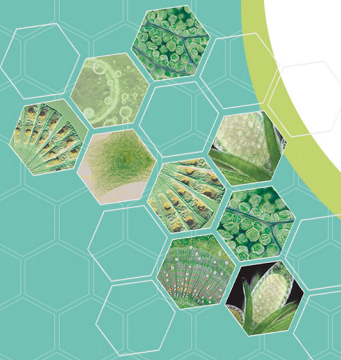

SMART SENSE SYSTEM

Clever energy-saving



The built in infrared device senses movement in front of the microscope (80 cm range). When there is no movement for 15 minutes the SMART SENSE system shuts down the illumination automatically and our Lotus saves energy when not in use.



ADVANCED LED SYSTEM

With very low power consumption and a bright illumination our LOTUS MCX51 works environmentally friendly and energy efficient.

SOPHISTICATED OBSERVATION WITH TRINOCULAR TUBE AND DOCUMENTATION SYSTEMS

Documentation systems are sophisticated solutions that allow microscope users to not only observe and study real-time images through the traditional eyepieces but also see the observation results on a screen. On the optional available trinocular observation tube various documentation systems can be mounted. Choose between digital compact cameras, digital SLR cameras, LIVE cameras with CMOS or CCD sensor or Full-HD video cameras.

To process the observation result, we offer a professional software system equipped with functions for digital photomicrography, image editing, measuring and counting. The software also features advanced exporting and reporting functions.

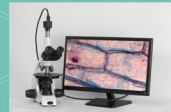

DOCUMENTATION SYSTEMS

Excellent digital images of fresh color grading for sophisticated life science applications. Microscopes with documentation systems are the ideal configurations for observation, presentation or teaching purposes.



ANTI-FUNGUS TREATMENT

Working in hot and humid climate is no problem for the LOTUS MCX51. Thanks to a special Anti-fungus treatment which is provided for the optical system, no damage will come to the optics and the pictures stay bright and clear.

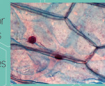

COMFORTABLE AND SAFE



The coarse coarse and calibrated fine focus controls are located on the right and on the left side of the microscope base. With the standard autofocus stop unit, collisions between the objective and the specimen are prevented which, avoids possible damage of both. The built in tension adjustment controls the mobility of the coarse coarse. Ergonomic arrangements of all the control elements ensure an effortless operation, graduation reading 2 µ per division.

TAKE EVERYTHING STAYS ON ITS PROPER PLACE



Single components which are easy to disassemble are fixed on the microscope ensuring that nothing gets lost while normal use, storage or transportation.

MINIMUM SPACE REQUIREMENTS



TRANSPORTATION AND STORAGE

The space-saving construction makes it possible to work in tight spaces where only little space is available and as a solid lightweight it makes it easy to transport and store. With the standard cord reel, also the power cable can be stored safely and nothing gets lost. Optional we offer an aluminum case for secure transportation.

REAR-FACING NOSEPIECE FOR A PERFECT SIGHT



The nosepiece is designed for 4 objectives and rear-facing. A reversed type-nosepiece creates more space on the stage and a perfect sight onto your specimen for much easier handling. The silver nosepiece ring with grooves ensures a good grip for rotating the nosepiece till the desired objective comes above the objective.

SAFETY ON/OFF DEVICE



The combination of power switch and brightness adjustment ensures the protection of the eyes. For turning off the Lotus MCX51, the brightness adjustment has to be on the lowest position. When turning on the microscope the brightness automatically is at its lowest position. With the safety relay control device no harm can come to the eyes of too bright light at full power when turning on the microscope.

NO POWER, NO PROBLEM



The optional available mirror unit makes the microscope suitable for indoor and outdoor use. Operating without the need of a power source, the mirror unit is also very helpful in areas with current fluctuations.

SIGHT ON THE SLIDES FROM EVERY DIRECTION



When the observation tube is reversed an opening on the back ensures an excellent sight on the table and on the slides.

micros micros micros micros micros micros micros micros micros micros micros